







img

gives

Contact information

If you have any questions when making this pattern, do not hesitate to contact me.
Also, I would love to see your finished amigurumi

-  linetr2011@gmail.com
-  GretaWings <https://www.instagram.com/gretawings/>
-  GretaWings https://www.facebook.com/grettawings/?ref=pages_you_manage
-  GretaWings <https://www.youtube.com/channel/UCz8UB400yzrx6XS9Ncvy7nA>
-  Greta Wings in English https://www.youtube.com/channel/UCr4xjdD89uaRXwKnJb6u7_g
-  GretaWings <https://gretawings.com/>

Important note:

Copyright

This pattern is for personal use only.
Its copying, translation or distribution
in any form is prohibited.

You can sell the final result of your
amigurumi in the way you choose.
If you sell your finished item online
please provide a link to our website in
your description and that way you
also support our project

This amigurumi is worked with well-
adjusted stitches and for the most part in a
spiral shape, do not close each round
unless I tell you to, you will have to be
careful and always mark the beginning of
each round. Please read the entire pattern
before beginning.

In the description, before buying this
pattern, I told you that we have a tutorial
on our channel to make this amigurumi.

You can enter the links that I share
attached to each image if you have any
questions.

If you detect any errors in this pattern
please contact me.



Copyright: This pattern is for personal use only. Its copying, translation or
distribution in any form is prohibited.

Amber is approximately 30cm tall.

Materiales:

- Hilaza Sinfonia 100% Algodón Mercerizado, mide aproximadamente 3mm de grosor y tiene 6 hebras. Colores: Carne o piel 890 (70g), Blanco 801, Tabaco 888, Canela Fuerte 843, Rosa 810
- Gancho de 2.5mm para hilaza Sinfonía
- Aguja Lanera
- Tijera
- Ojos de seguridad de 10mm
- Marcador temporal
- Alfileres
- Barra de Silicon (pegamento)
- Relleno para amigurumis
- Velcro (cierre de la blusa)
- Rubor para las mejillas y orejas
- Alambre (para la diadema)

Abbreviations:

- R: Round
c: chain
AM: Magic Ring
sc: single crochet
dec: decrease (close 2 sc together)
inc: increase (2 sc in 1 stitch)
triple inc: increase (3sc in 1st)
hdc: half double crochet
FLO: Front Loop Only
BLO: Back Loops Only

https://youtu.be/9VT_o2hqeSY?t=43

Note: You can use this same pattern to make this amigurumi larger or smaller using a thread of greater or lesser thickness and depending on this thread will be the hook number, in the same way you will choose the desired size of the safety eyes

I hope you enjoy this pattern as much as I did designing it for you.



Copyright: This pattern is for personal use only. Its copying, translation or distribution in any form is prohibited.

Let's start with the body

Arms (x2)

Use flesh-colored yarn or the one you choose for the skin

R1: MR 6sc

R2: 6inc (12)

R3-4: 12sc

R5: 5sc, (bobble stitch: 4hsc closed together in the same place), 6sc (12)

R6: 12sc

R7: (4sc, 1dec)x2 (10)

R8-24: 10sc

<https://youtu.be/I1-HpjU3zGk?t=395>



Cut strand at the end of each Arm and Fill in just a little

Legs (x2)

Start with flesh-colored yarn or whatever you have chosen for the skin.

R1: 4ch, in the 2nd start (2sc, 1 triple inc)x2 (10)

Note: I suggest you mark Chain number 4

before starting the first single crochet,

because once we knit the 2nd repeat on the

other side of the chains, that 4th chain is

where we will do the last triple increase



<https://youtu.be/I1-HpjU3zGk?t=700>

R2: (2sc, 3inc)x2 (16)

R3: 3sc, 4inc, 4sc, 4inc, 1sc (24)

R4: BLO 24sc



<https://youtu.be/I1-HpjU3zGk?t=906>

R5-7: 24sc



<https://youtu.be/I1-HpjU3zGk?t=945>

Note: Before continuing, fill the plant with silicone glue, if you still do not know our technique, please enter the link that I share with you



R8: 6dec, 12sc (18)

R9: 18sc

R10: 3dec, 6sc, 1dec, 4sc (14)

R11-30: 14sc Change to yarn color White

In the first leg that you made, you will cut the thread and in the second leg you will change to White color yarn in the last single crochet of the R30 to make the underwear

R31: 2ch, 14sc in the other leg, 2sc in the 2ch, 14sc in the leg that started this R. (32)

<https://youtu.be/l1-HpjU3zGk?t=1280>



R32-36: 32sc

R37: (6sc, 1dec)x4 (28) Change to Flesh color on the last decrease of this R



<https://youtu.be/l1-HpjU3zGk?t=1545>



R38: 28sc

R39: (5sc, 1dec)x4 (24)

R40-48: 24sc



R49: 9sc, 10sc in one arm, 12sc, 10sc en el otro brazo, 3sc (44)



Note: Place Marker on each side, right where you marked is where you will join the arms.



R50: (2sc, 1dec)x11 (33)

R51-52: 33sc

R53: (1sc, 1dec)x11 (22)

R54: 22sc

<https://youtu.be/I1-HpjU3zGk?t=1665>



<https://youtu.be/I1-HpjU3zGk?t=2000>

Note: You must fill in as the fabric progresses and create a hole to then insert the silicone tube or the material you want to use to support his head.

Note: Be sure to always place your thumb towards the front of your amigurumi.



R55: 11dec(11)

R56-57: 11sc

R58: 1inc, 10sc (12)



Head

<https://youtu.be/ohet1slsWmk?t=41>

R59: 12inc (24)



R60: (3sc, 1inc)x6 (30)

R61: (4sc, 1inc)x6 (36)

R62: 2sc, 1inc, (5sc, 1inc)x5, 3sc (42)

R63: (6sc, 1inc)x6 (48)

R64: 3sc, 1inc, (7sc, 1inc)x5, 4sc (54)

R65: 54sc

R66: (8sc, 1inc)x6 (60)

R67: 4sc, 1inc, (9sc, 1inc)x5, 5sc (66)

R68: (10sc, 1inc)x6 (72)



<https://youtu.be/ohet1slsWmk?t=412>

Note: You will need to create a hole in the body, prepare the silicone tube by creating a fine point for it to go in easier and then push the silicone in, you can actually put it in whenever you like

R69-77: 72sc



R78: (10sc, 1dec)x6 (66)

R79-81: 66sc

Place the eyes between R73 and 74
with approximately 13 points of separation



Note: If you would like to further secure these eyes, watch our video I show you in detail how to do this, but it's optional.

<https://youtu.be/ohet1slsWmk?t=587>



Face embroidery

Note: You need to visit our video for all the details of the face, it will be easier for you

<https://youtu.be/ohet1slsWmk?t=719>



<https://youtu.be/ohet1slsWmk?t=830>

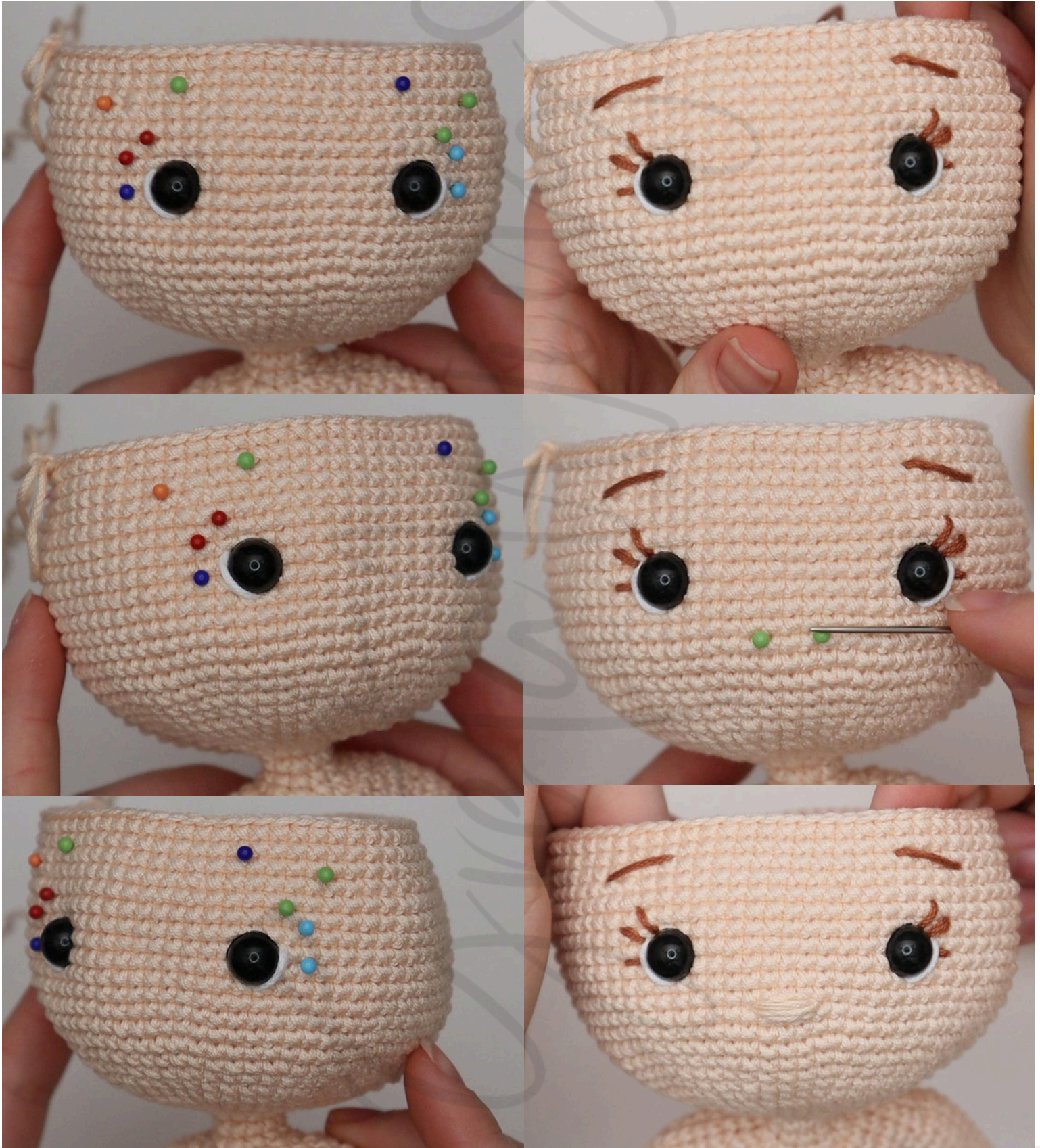

Copyright: This pattern is for personal use only. Its copying, translation or distribution in any form is prohibited.

Ears (x2)

We will make the ears with 8 points of separation from each eye

In their points they will be the same, the different thing will be where to start each one

1ch, 1sc, 5hdc in the same stitch, 1sc, 1ss



<https://youtu.be/ohet1slsWmk?t=1204>

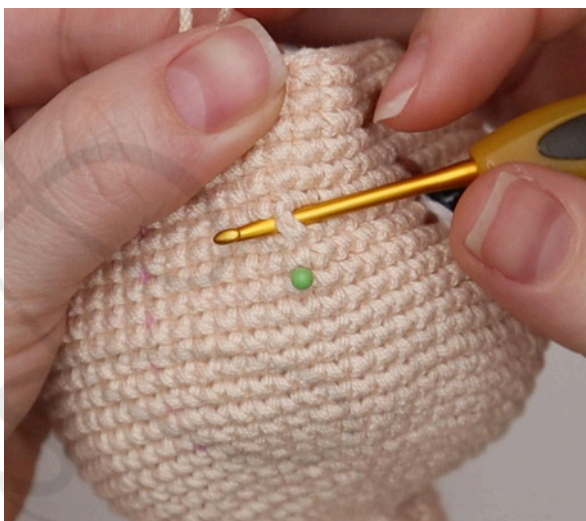



R82: (9sc, 1dec)x6 (60)

R83: 3sc, 1dec, (8sc, 1dec)x5, 5sc (54)

R84: (7sc, 1dec)x6 (48)

R85: 3sc, 1dec, (6sc, 1dec)x5, 3sc (42)

R86: (5sc, 1dec)x6 (36)

<https://youtu.be/ohet1slsWmk?t=1750>

R87: (4sc, 1dec)x6 (30)

R88: (3sc, 1dec)x6 (24)

R89: (2sc, 1dec)x6 (18)

R90: (1sc, 1dec)x6 (12)

R91: 6dec (6)

Close with a wool needle

See the link and you will understand how we close our amigurumis



Note: I have introduced the silicone once more, to cut it and be able to fill



Apply blush only if desired.

https://youtu.be/_aEliBWh5nk?t=1547





Hair

Use strong tan color yarn and start with 1slip knot

[54ch, in the 2nd star (1hdc, 1hdc inc)x10, 32hdc, 1sc]x20

1ch to secure and cut the strand, no length is needed, glue or sew the hair with a finer strand, it is always recommended to sew for greater security.

https://youtu.be/9VT_o2hqesY?t=493

https://youtu.be/9VT_o2hqesY?t=659





Diadem

Use white thread

R1: MR 6sc

R2-50: 6sc

Close with wool needle, before placing wire.

<https://youtu.be/Fp6IWWAWI3k?t=59>

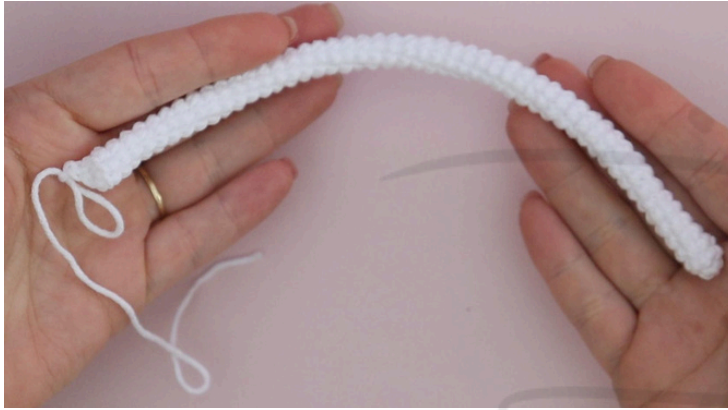

Cut the wire according to the length of the previous piece, it must be a wire that when placed on the head maintains the desired curvature.

<https://youtu.be/Fp6IWWAWI3k?t=222>

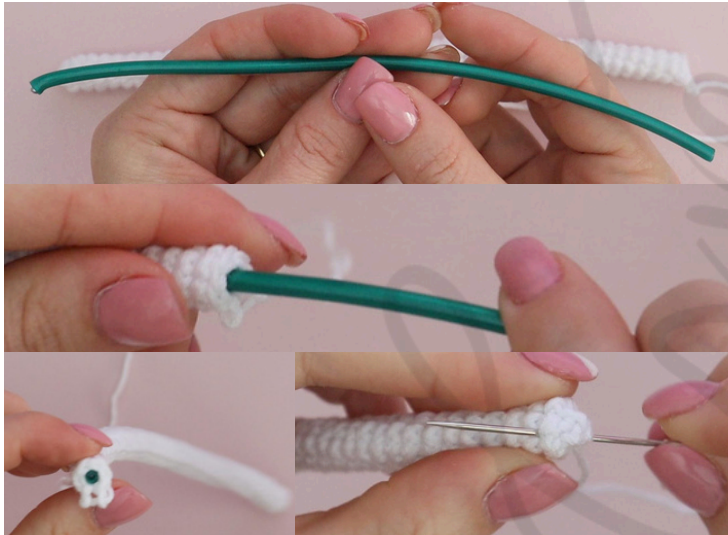

Ears (x2)

<https://youtu.be/Fp6IWWAWI3k?t=321>

Use white color yarn

R1: MR 6sc

R2: (1sc, 1inc)x3 (9)

R3: (2sc, 1inc)x3 (12)

R4: (3sc, 1inc)x3 (15)

R5: (4sc, 1inc)x3 (18)

R6-10: 18sc

R11: (4sc, 1dec)x3 (15)

R12: 15sc

R13: (3sc, 1dec)x3 (12)

R14-16: 12sc

Close with a wool needle joining one side to the other and then with a double stitch that base, leaving a thread to join each ear to the previous piece. Add blush to taste.

<https://youtu.be/Fp6IWWAWI3k?t=560>





R5: BLO 28ss (28)

R6: BLO 28sc (28)

R7-9: 28sc (28)

<https://youtu.be/sGEy9KIWLLg?t=388>

Shoes (x2)

<https://youtu.be/sGEy9KIWLLg?t=45>

Start using pink thread

Start with 1 slip knot.

R1: 4ch, in the 2nd start (2sc, 1triple inc)x2 (10)

R2: (2sc, 3inc)x2 (16)

R3: (2sc, 6inc)x2 (28)

<https://youtu.be/sGEy9KIWLLg?t=188>

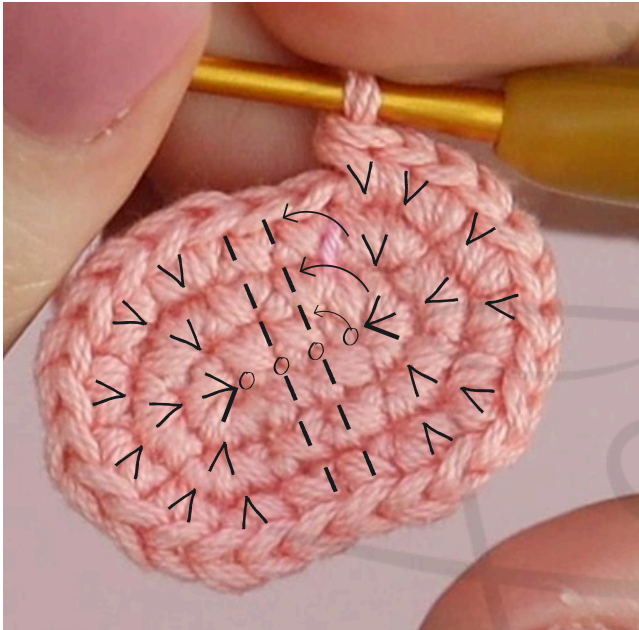

R4: BLO 28sc (28) Change to White color yarn

<https://youtu.be/sGEy9KIWLLg?t=238>



R10: 2sc, 6dec, 7sc, 1dec, 5sc (21)

Close using wool needle (see video)

<https://youtu.be/sGEy9KIWLLg?t=477>



Shoe ears (x2)

Start with 1 slipknot and white thread.

(6ch, in the 3rd beg BLO 2hdc, 1sc, 1ss)x2

Leave the long thread at the beginning and at the end to attach to the shoe, in the front of each shoe and as centered as possible between rounds 9 and 10.

<https://youtu.be/sGEy9KIWLLg?t=534>





Then with white thread work on the indicated strands, starting in the center of the closing seam, for greater understanding see video.

https://youtu.be/_aEliBWh5nk?t=272



Skirt

Start with 1 slip knot. and pink thread for the waist

R1: 5ch, in the 2nd start BLO 4ss (4)

R2-46: 1ch, turn, 4ss (4)

Close with wool needle

https://youtu.be/_aEliBWh5nk?t=31



R1: 1ch, in the same base begin 23hdc inc, 1ss (46)

https://youtu.be/_aEliBWh5nk?t=306



R2: 1ch, 46hdc (46)

R3: 1ch, FLO 46hdc (46) Change to pink color yarn

R4: (1ch, 1ss)x46.

https://youtu.be/_aEliBWh5nk?t=464



https://youtu.be/_aEliBWh5nk?t=203

Turn the piece over and make sure this seam is facing inwards.





Extra ruffles

Start with white color yarn

R1: 1ch, BLO 46hdc (46)

R2: 1ch, 46hdc (46)

R3: 1ch, FLO 46hdc (46) Change to pink color, do not cut the white strand if you want to continue making ruffles.

R4: (1ch, 1ss)x46.

Repeat from R1 to R4 one more time.

https://youtu.be/_aEliBWh5nk?t=558



https://youtu.be/_aEliBWh5nk?t=775

Use white color yarn

R1: 31ch, in the 2nd start 30sc (30)

R2-4: turn, 30sc (30) (30)

R5: turn, 8sc, 13ch, skip 1st, 12sc, 13hc, skip 1st, 8sc (54)

R6: turn, 9sc, 2hdc, 7dc, 2hdc, 14sc, 2hdc, 7dc, 2hdc, 9sc (54)

R7: 54sc Change to pink color yarn

R8: turn, ss all around the edge of the blouse, make a chain to close the piece.

https://youtu.be/_aEliBWh5nk?t=1313



Place a zipper, cut a small piece of Velcro and glue it, one piece below and one above at the ends of the blouse.

https://youtu.be/_aEliBWh5nk?t=1380



Congratulations! You have completed your amigurumi.

If you have enjoyed our pattern and decide to share your final work on your social networks, don't forget to tag us so we can admire your result.

Please remember that this is a paid pattern that I have put a lot of time and love into. I ask you please, out of respect for our project, not to share it in groups or on the web, as it does us a great disservice. Even if you have purchased the pattern, please remember that you are purchasing the pattern and not the copyright, which belongs to GretaWings. Thank you! purchased, you are purchasing the pattern not the copyright and the rights to it belong to us GretaWings, thank you

